

Parklands

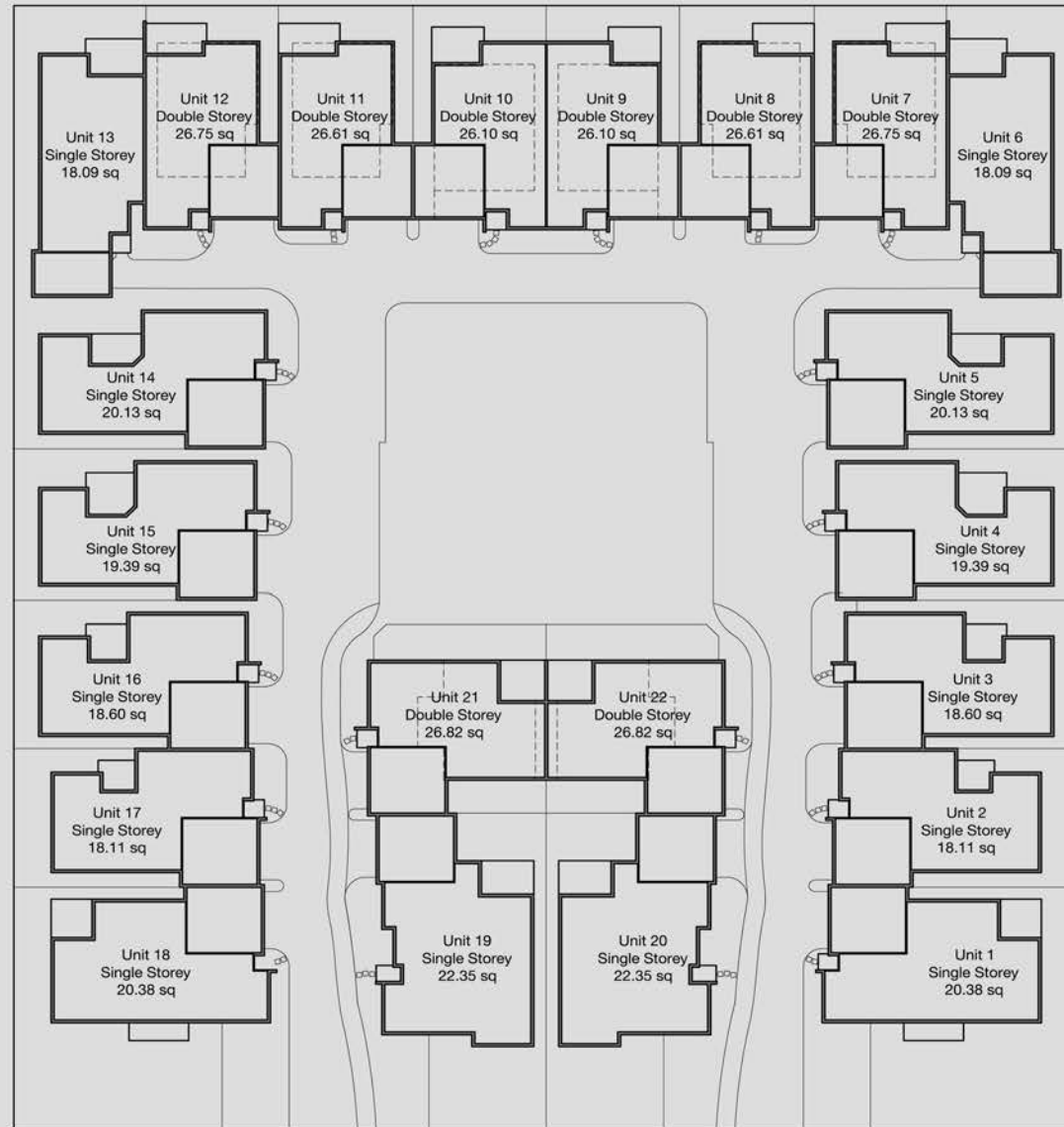

2 Fuji Crescent Mornington 3931
T: (03) 5977 1607 F: (03) 5977 1609
www.gilpihomes.com.au

Parklands



Copyright Gilpip Homes Pty Ltd. All rights reserved. All plans are copyright, no part may be used, reproduced or copied by any means or in any form without the prior permission of Gilpip Homes Pty Ltd.

All measurements are in millimeters unless otherwise stated. Lot widths are based on the base façade, and may vary depending on the façade chosen. Due to estate requirements and council guidelines some lot width requirements will change. Plans are subject to change. To be used as a guide only.



2 Fuji Crescent Mornington 3931
T: (03) 5977 1607 F: (03) 5977 1609
www.gilpiphomes.com.au